

# Peacemaker® Wall Installation Instructions:



Typical Layered Wall Installation Guide Notes:

Installing Peacemaker is a two-person job. Peacemaker is most effective when sandwiched between two rigid structures like existing stud and a new layer of drywall. Be sure to tape all Peacemaker seams (vertical or horizontal) at least twice. Seal every electrical box, switch box or other penetration with acoustical sealant to increase effectiveness- DO NOT use ordinary caulk.



## Instructions:

1. Measure the height and length of the walls to determine the square footage of Peacemaker that is needed.
2. Only cut Peacemaker as necessary. Fewer cuts and seams will ultimately produce better sound blocking performance.



3. Determine where Peacemaker seams will meet across the studs. If seams meet between the studs, overlap both ends of Peacemaker and tape the seam twice. This adds rigidity and increases the product's overall effectiveness. If seams meet on the studs, taping is not necessary but highly recommended to create a more airtight space.



4. Begin unrolling Peacemaker across the studs.

5. Attach 5 fasteners along the lead stud, and 5 fasteners along the bottom, making sure Peacemaker is flat and aligned with the wall. \*It is important to fasten, stretch, and fasten as you go. Roll Peacemaker down the wall, attaching 5 fasteners along the lead stud, and 5 fasteners along the bottom.



**Note:** Peacemaker is always hung across studs, NOT parallel to them. Thus, it will take more than one piece to cover the wall from wall to ceiling.

6. As necessary, make cutouts for electrical box, switch boxes, etc. It is not recommended to wait until the project is complete.



7. Check all fasteners to make sure they are flush to the wall, then check all seams and cutouts to make sure there is a tight fit.

8. When all the walls are covered with Peacemaker, it's time to seal.

Go back and make sure all vertical and horizontal seams are taped using a staggered layer of foil or vinyl tape. You will also need to seal all cutouts with acoustical caulk.

## New Wall Construction:

Peacemaker® is easily stapled to the studs behind your drywall layer.

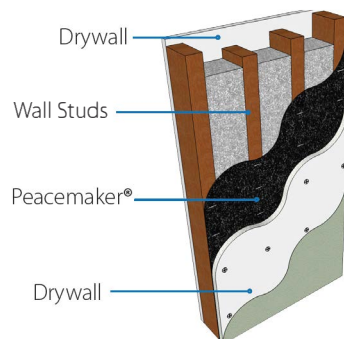

## Retrofit Construction:

Peacemaker® can be installed directly on top of wall surface and closed behind a new sheet of drywall or other finished surface.

